





SINDI CASTILLO

Biology
Beaumont, TX

"I AM THANKFUL AND PROUD TO GROW
INTO MY VALUES AT LU."

Lamar University has offered me various opportunities to be a part of different experiences. I've embedded myself into the campus community and have gained caring and supportive friends, mentors, and peers. Along with my friends and classmates, my intellectual growth can be credited to the smaller class sizes and to the dedicated professors that care about my future. Through LU, I have gained research experiences through a grant that has allowed me to network and hone the skills for my future success.

Honors Student Association (HSA), Lamar Rotaract,
American Medical Society Association (AMSA),
Orientation Leader on Cardinal Orientation
Team, Dr. Jack Orrick Scholarship for Pre-Med
Students, McMaster Honors Scholarship, Office of
Undergraduate Research Grant: The inflammatory
investigation of cervical cancer cells in response to
Trichomonas Vaginalis



SINDI, SENIOR



RESIDENCE LIFE

Residence Life at Lamar University provides safe, inclusive and secure residential communities where a diverse, innovative and responsive team of professionals encourages students to pursue academic excellence, personal growth, civic leadership and responsibility.



ON CAMPUS AMENITIES

- Convenient access to Student Health Center
- Controlled-card-access entry
- Close to Recreational Sports Center with evening and weekend hours
- Live-in professional staff
- Convenience store with Papa John's Pizza
- On-site laundry facilities
- 24-hour security monitoring
- Swimming pool
- Full kitchen for residents' use
- High-speed wired and wireless internet
- Cable TV
- Study areas and community activity centers
- All-inclusive cost
- Special activities and events just for residents

TWO-PERSON SUITE

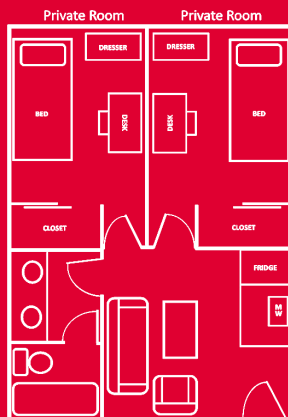

THREE-PERSON SUITE

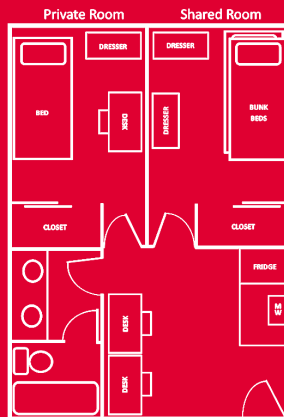

WHAT'S INCLUDED

- WIFI
- CABLE
- 8' X 10' ROOM
private or shared with one roommate
- XL TWIN BED
- SHARED BATHROOM
with one or two roommates

WHO IS LU?

CREATE YOUR OWN EXPERIENCE

APARTMENT-STYLE

living with private rooms



**FREE
TICKETS**
*to athletic
events*

130,000 SQ. FT.

*Shelia Umphrey
Recreational Sports
Center*



STUDY ABROAD
opportunities

INTERNATIONAL *and* AMERICAN *cuisine*

- Brooks-Shivers Dining Hall
- Starbucks
- Chick-fil-A
- Panda Express
- Smoothie King
- SSC Market
- Tiny House BBQ
- Big Red Food Truck
- Big Red Juice Bar
- Papa John's Pizza



**GREEK LIFE
CONCERTS
EXHIBITIONS**



**STUDENT
ORGANIZATIONS**

*for professional
development and fun*

17 NCAA DIVISION I *athletic teams*

Baseball ♂

Basketball ♀♂

Cross Country ♀♂

Football ♂

Golf ♀♂

Soccer ♀

Softball ♀

Tennis ♀♂

Track & Field ♀♂

Volleyball ♀

PAYING *for* COLLEGE

SCHOLARSHIPS & FINANCIAL AID

Lamar University offers quality and affordability. With low tuition and many financial aid and scholarship opportunities, LU can help make YOUR college education possible.

Scholarships will be awarded to students who are admitted on a test-optional basis as well as SAT/ACT scores.

COSTS

A typical budget for one semester for a student living on campus includes costs for tuition and fees, room and board, books and supplies.

Tuition/Fees	\$5,200*
Room.....	\$3,000
Board	\$1,500
Books/Supplies.....	\$600
Total	\$10,300

Tuition costs are lower for Texas residents. Residents of Louisiana pay in-state tuition rates plus \$30 per credit hour. Residents of other U.S. states and other countries pay out-of-state tuition.

* Costs are estimates and are subject to change. Tuition and fees based on approximate costs for Texas resident taking 15 credit hours.



**Top
Scholars
Program**

\$80,000 FOUR-YEAR TOTAL

PRESIDENTIAL SCHOLARSHIP & SOUTHEAST TEXAS LEGENDS SCHOLARSHIP

3.85+ GPA

AND

CLASS RANK Top 25%

AND
HOLISTIC REVIEW OF ACADEMIC PERFORMANCE

\$74,000 FOUR-YEAR TOTAL

SMITH-HUTSON SCHOLARSHIP

BASED ON ACADEMIC ACHIEVEMENT & NEED

\$40,000 FOUR-YEAR TOTAL

CARDINAL ELITE SCHOLARSHIP

3.85+ GPA

AND

CLASS RANK Top 25%

\$32,000 FOUR-YEAR TOTAL

ACADEMIC EXCELLENCE SCHOLARSHIP

3.8-3.84 GPA

AND

CLASS RANK Top 25%

\$20,000 FOUR-YEAR TOTAL

DISTINGUISHED SCHOLARS

3.7-3.79 GPA

AND

CLASS RANK Top 25%

\$4,000 FOUR-YEAR TOTAL

UNIVERSITY SCHOLARS

3.65-3.69 GPA

AND

CLASS RANK Top 25%

**PRIORITY DEADLINE DECEMBER 1.
DEADLINE TO APPLY FEBRUARY 1.**

LU AWARDS MORE THAN \$20 MILLION IN SCHOLARSHIPS EACH YEAR. COMPLETE YOUR FAFSA AND TASFA AND USE CODE 003581 TO BE ELIGIBLE FOR ADDITIONAL FINANCIAL AID.

*High school GPA will be re-calculated on a 4.0 collegiate scale

**Class rank requirements will not apply to homeschool students or high-schools that do not rank students

Scholarships
(409) 880-1714
scholarships@lamar.edu

➤➤ lamar.edu/scholarships

Financial Aid
(409) 880-8450
financialaid@lamar.edu

➤➤ lamar.edu/financialaid

VISIT US ON CAMPUS



SCHEDULE A VISIT

Monday-Friday

Guided, 90 minute walking tours of campus depart from the Admissions Visitors Center in the John Gray Center, Herman Iles Building, 855 Jim Gilligan Way, Beaumont, TX 77705.

Group visits available. Schedule your visit to LU at lamar.edu/visit.

CARDINAL SATURDAYS

For future Cardinals who cannot visit on weekdays, Saturday tours are available on select dates by appointment at 10 a.m.

CARDINAL VIEW

Students and their families learn about academic majors, student life on campus, a host of student-driven organizations, financial aid opportunities and scholarship potential. It is the time to get that all-important head start.

To register, visit
lamar.edu/cardinalview.

DATES

- > Nov. 14, 2020
- > Feb. 13, 2021

CAN'T MAKE IT TO CAMPUS?

Check out our virtual tour! This tour will give you a sneak peak of the campus as well as panoramic views inside classrooms and other specialty areas such as the recital hall, nursing simulation lab and engineering labs.

>> [LAMAR.EDU/VISIT](https://lamar.edu/visit)





LAMAR UNIVERSITY

MEMBER THE TEXAS STATE UNIVERSITY SYSTEM™

YOUR
Moment
IS HERE

**GO AHEAD. TAKE FLIGHT.
ACCEPT THE CHALLENGE.**

you'll be ready
..... *to*

start your story

We take care of you so you can take care of your future.



lamar.edu/admissions

Lamar University is an equal opportunity/affirmative action educational institution.